



*A Livable Community*  
By Don Tierney

FOR MORE INFORMATION:  
608-837-0102 | 608-575-6538  
DONTIERNEY.COM



KRISTIN LEMKE  
WI RE PROFESSIONALS  
608-220-3528

WISCONSINREALESTATEPROFESSIONALS.COM



New Phase - Single Family

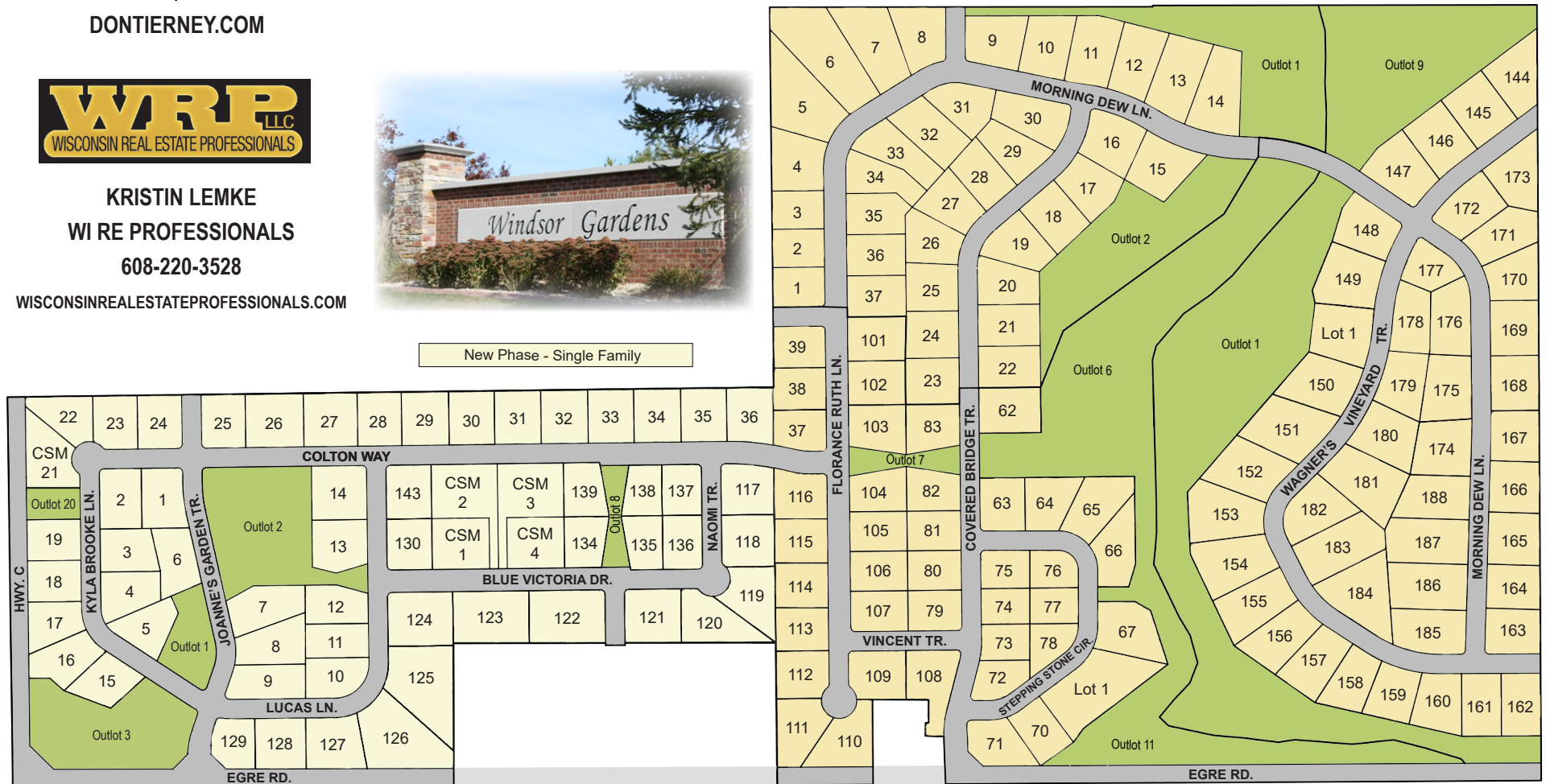

*Charming Country Views* with Rural Heritage  
in the Village of Windsor